

An aerial photograph of a row of Victorian terraced houses in London. The houses are built of light-colored brick with dark brown tiled roofs. They feature multiple windows, some with white frames, and small front gardens with white-painted brick walls. A paved street runs alongside the houses, with a motorcycle parked on it. In the background, more houses and trees are visible under a clear blue sky.

Julian Reid

84b Lordship Park, London, N16 5UA

A super two bedroom, two bathroom flat on the raised ground floor of this converted Victorian house boasting wonderfully elegant rooms with great ceiling height and a sunny, south facing roof terrace.

julianreid.co.uk

Guide Price £750,000
Share of Freehold

- **2 Bedrooms**
- **Council Tax Band: D**
- **EPC Rating: D**
- **2 Bathrooms (1 en-suite)**
- **South facing terrace**

A very elegant converted flat arranged on the raised ground floor of this fine, late Victorian house located on a popular road just north of Clissold Park. The flat boasts bright rooms in excellent order throughout with great ceiling height and large, bright bay window in the reception room. Super living space with a well-planned Kitchen area. Large master bedroom and modern bathroom with second bedroom to the rear with en-suite shower room. There is access from the rear onto a south facing roof terrace. Lordship Park is located just north of Clissold Park and ten minutes walk from Stoke Newington Church Street. There are regular bus services to Finsbury Park and Stoke Newington overground station which provides a regular service into Liverpool Street is also within walking distance.



Julian Reid
51 Stoke Newington Church Street London N16 0AR
jreid@julianreid.co.uk Fax: 020 7923 8651
+44 (0) 20 7923 8650

Lordship Road, N16

Approximate Gross Internal Area = 872 sq ft / 81 sq m

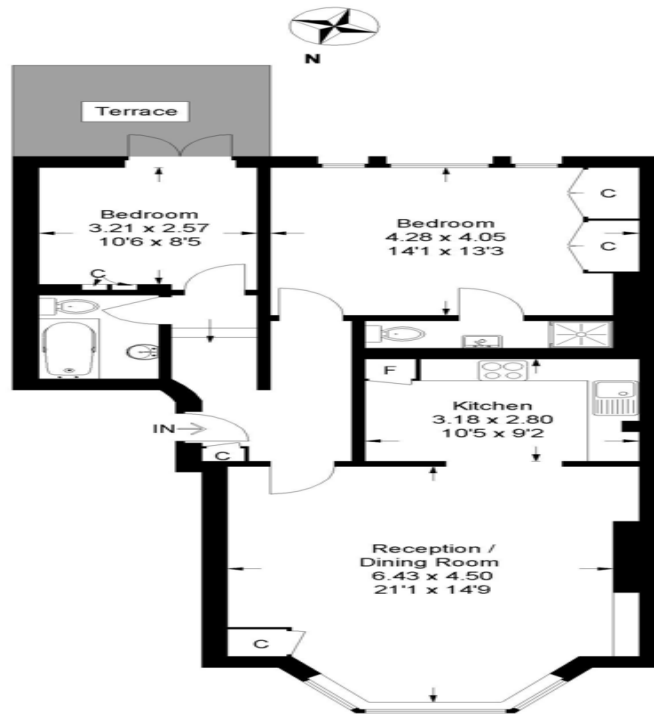

Raised Ground Floor

For Illustration Purposes Only - Not To Scale
Floor plan for Julian Reid
Ref: 94183

Important notice: Julian Reid, their clients and any joint agents give notice that: **1:** They are not authorized to make or give representations or warranties in relation to the property either here or elsewhere, either on their own behalf or on behalf of the client or otherwise. They assume no responsibility for any statement that may be made in these particulars. These particulars do not form part of any offer or contract and must not be relied upon as statements or representations of fact. **2:** Any areas, measurements or distances are approximate. The text, photographs and plans are for guidance only and are not necessarily comprehensive. It should not be assumed that the property has all necessary planning, building regulation or other consents and Julian Reid have not tested any services, equipment or facilities. Purchasers must satisfy themselves by inspection or otherwise.

