

Julian Reid



6 Myddleton Avenue, London, N4 2DP
Wonderfully light and spacious one bedroom flat, with allocated parking space. Large living room and separate kitchen. Freshly decorated throughout with new carpets. Available immediately and offered part furnished.



£1,500 per calendar month

- One bedroom
- Council Tax Band: C
- EPC Rating: TBC
- Large living room
- Separate kitchen

A very large one double bedroom flat arranged over the first floor of a small modern block in this gated development, with allocated parking. The property sits between Finsbury Park and Clissold Park and is a short stroll to Manor House Tube station. Available Immediately and offered part furnished.

Myddleton Avenue

Approximate Gross Internal Area

First Floor = 559 sq ft / 51.93 sq m

Total = 559 sq ft / 51.93 sq m

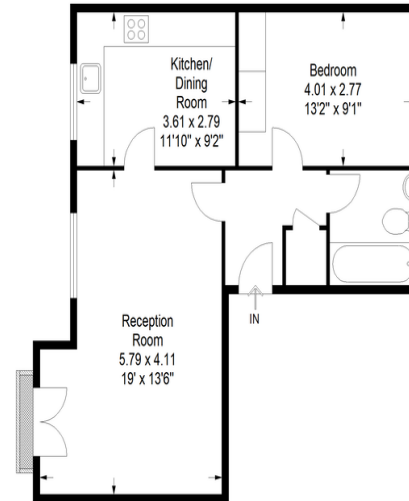

First Floor

JULIAN REID SPECIAL DISCLAIMER:-
For Illustration Purposes Only - Not To Scale
Floor plan For Julian Reid



Julian Reid

51 Stoke Newington Church Street London N16 0AR

jreid@julianreid.co.uk Fax: 020 7923 8651

+44 (0) 20 7923 8650

Important notice: Julian Reid, their clients and any joint agents give notice that: 1: They are not authorized to make or give representations or warranties in relation to the property either here or elsewhere, either on their own behalf or on behalf of the client or otherwise. They assume no responsibility for any statement that may be made in these particulars. These particulars do not form part of any offer or contract and must not be relied upon as statements or representations of fact. 2: Any areas, measurements or distances are approximate. The text, photographs and plans are for guidance only and are not necessarily comprehensive. It should not be assumed that the property has all necessary planning, building regulation or other consents and Julian Reid have not tested any services, equipment or facilities. Purchasers must satisfy themselves by inspection or otherwise.



J352 Ravensworth 01670 713330